



# THE LAST WORD

[www.anpautograph.com](http://www.anpautograph.com)



ANP Corp aims to reach newer horizons with every project it creates by introducing innovations and setting new standards in the industry with sheer hard work, while relentlessly adopting new trends at the execution level.



Conceptual Image



27 YEARS  
IN THE INDUSTRY



25 PROJECTS  
DELIVERED ON TIME



3500+  
HAPPY CUSTOMERS



3.2 MILLION SQ.FT.  
DELIVERED TILL DATE



5 MILLION SQ.FT.  
UNDER CONSTRUCTION



2 MILLION SQ.FT.  
TO BE LAUNCHED  
(BEFORE 2024)

WE ARE  
PARTICULAR

APRPH

**AP**  
**AUTOGRAPH**

**DISTINCT 4, 3 & 2 BHK HOMES**  
**AUNDH-RAVET BRTS ROAD**

TUJG

A



## LOCATION HIGHLIGHTS

HOTELS	7+
SCHOOLS & COLLEGES	7+
HOSPITALS & CLINICS	6+
ENTERTAINMENT AVENUES	5+



## KEY DISTANCES

### SCHOOLS & COLLEGES

BALAJI LAW COLLEGE - 1.3 KMS  
 ORCHIDS INTERNATIONAL SCHOOL - 1.8 KMS  
 SMT ANUSAYA OVHAL MADHYAMIK SCHOOL - 3.2 KMS  
 INDIRA COLLEGE - 3.5 KMS  
 D. Y. PATIL INTERNATIONAL UNIVERSITY - 3.9 KMS  
 LOTUS BUSINESS SCHOOL - 3.9 KMS  
 PUNE BUSINESS SCHOOL - 4.8 KMS

### HOSPITALS

PULSE HOSPITAL - 2.1 KMS  
 LIFE CARE HOSPITAL - 3.4 KMS  
 FLORA MULTISPECIALITY HOSPITAL - 3.6 KMS  
 ADITYA BIRLA HOSPITAL - 4 KMS  
 PHOENIX HOSPITAL - 4.5 KMS  
 7 ORANGE HOSPITAL - 5.5 KMS  
 NIRAMAYA HOSPITAL - 8.2 KMS

### HOTEL

SAYAJI HOTEL - 4.5 KMS  
 VIVANTA PUNE - 7.5 KMS  
 HYATT PLACE - 7.6 KMS  
 LEMON TREE HOTEL - 7.7 KMS  
 COURTYARD BY MARRIOTT - 7.8 KMS  
 THE ORCHID HOTEL - 8.7 KMS

### ENTERTAINMENT AVENUES

VISION ONE MALL - 3.4 KMS  
 ELPRO CITY SQUARE MALL - 6.0 KMS  
 XION MALL - 7.4 KMS  
 CITY ONE MALL - 8.3 KMS  
 GRAND HIGHSTREET - 8.7 KMS

# ANP AUTOGRAPH

**DISTINCT 4, 3 & 2 BHK HOMES  
AUNDH-RAVET BRIS ROAD**

A testament to the epitome of luxury and sophistication, **ANP Autograph** is more than just a residential project. Situated amidst the serene neighbourhoods of Aundh and Ravet, every aspect of this project is crafted to redefine modern living standards. From its stellar architecture to thoughtfully designed interiors, the structure is the embodiment of elegance and exclusivity. With a range of distinct 4, 3, and 2 BHK residences, this landmark development exemplifies unparalleled craftsmanship giving each of its residents a unique living experience. Experience the allure of **ANP Autograph** and indulge in truly extraordinary lifestyles.





# MASTER LAYOUT



# THE LAST WORD IN PERFECTION

At **ANP Autograph**, we have the last word in perfection, as this project is synonymous with perfection in every sense. From the moment you step into the opulent lobby to the time you retreat to your exquisitely designed residence, you will be enveloped in an aura of perfection. The attention to detail is evident in every nook and corner, showcasing the finest finishes, state-of-the-art amenities, and a harmonious blend of functionality and aesthetics. This landmark project is the ultimate expression of perfection, promising a surreal living experience that surpasses all expectations.





**A GRAND GATEWAY ADORNED  
WITH ELEGANCE**

# THE LAST WORD IN FINESSE

The dynamic structure of **ANP Autograph**, its expansive living spaces, its plethora of amenities, and its location exude finesse and sophistication. From the moment you enter its premises, you will be captivated by all that it offers. With its perfect blend of modern aesthetics and classic charm, this project provides a certain flair to your everyday life. Every space here is crafted with utmost care, boasting premium finishes, high-quality material, and meticulous attention to detail. The project stands as an ode to finesse, promising a lifestyle that is refined, graceful, and truly extraordinary.



# ANP AUTOGRAPH

DISTINCT 4, 3 & 2 BHK HOMES  
AUNDH-RAVET BRTS ROAD



# THE LAST WORD IN LIFESTYLE

When it comes to providing premium lifestyles, **ANP Autograph** has the last word. The project promises a haven of luxury and indulgence, where every aspect has been carefully curated to cater to your discerning tastes. Immerse yourself in a world of extravagance, where breathtaking views, lush landscapes, and world-class amenities await you at every turn. Whether you seek relaxation or recreation, **ANP Autograph** has it all. Filled to the brim with rejuvenating facilities, amenities, serene green spaces, and vibrant social gathering avenues, this residential paradise offers an unmatched living experience that redefines the meaning of luxury.



## GROUND LEVEL AMENITIES

- Kids' Adventure Park
- Multipurpose Play Court
- Glamping
- Seating Court
- Calisthenics
- Tree Deck
- Pets' Park
- Climbing Wall



Multipurpose Play Court



Glamping



Artistic Impression

Kids' Adventure Park

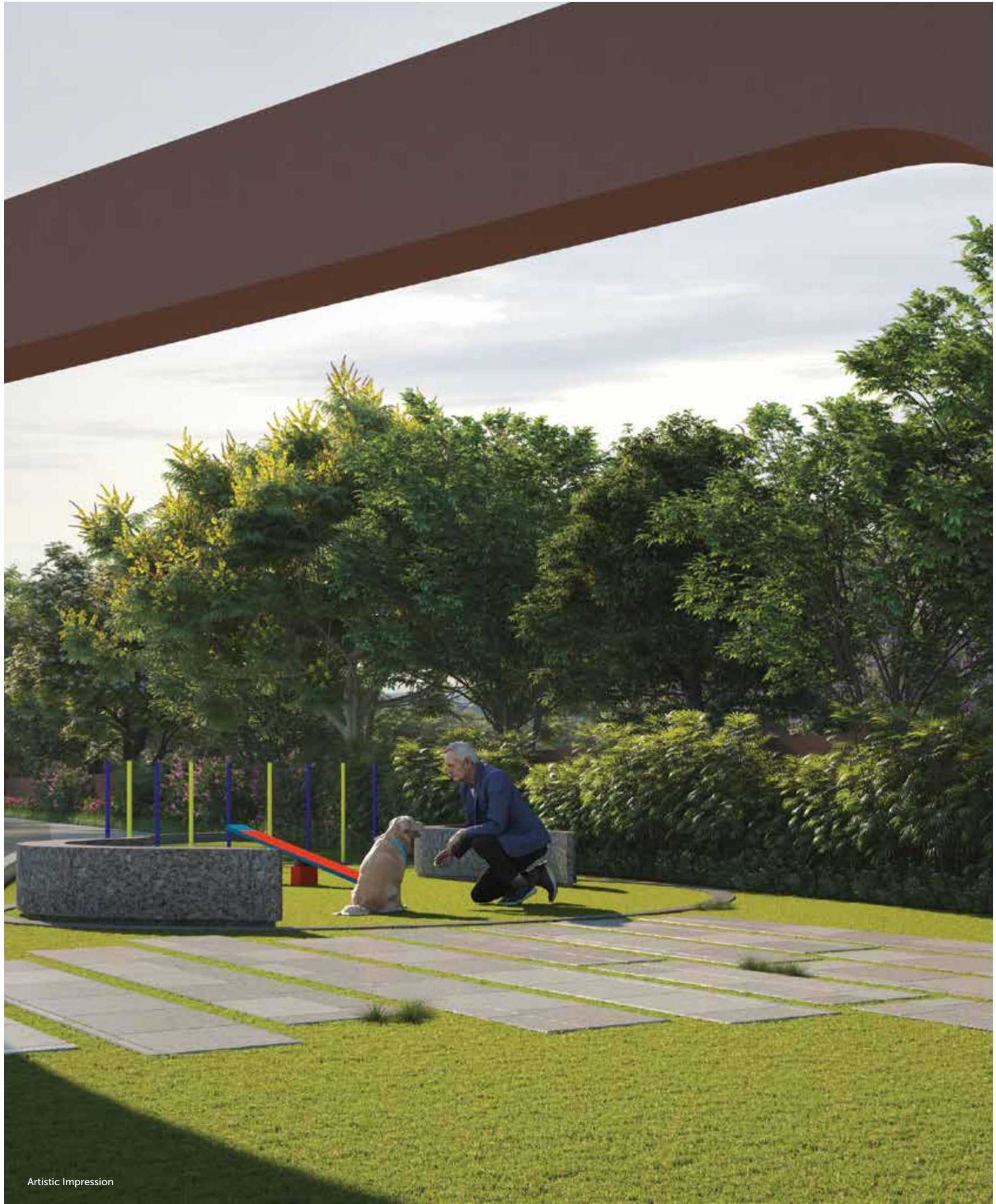

Artistic Impression

Pets' Park

## PODIUM LEVEL AMENITIES

- Pool Complex
- Lounge Area
- Deck Seating
- Sculptural Pedestal
- Seating Surrounding Planter
- Sand Pit
- Seating with Pergola
- Party Lawn
- Deck
- Amphi-seating with Sculptural Pedestal
- Sensorial Park in Forested Area







Artistic Impression

Seating Surrounding Planter



Artistic Impression

Sensorial Park in Forested Area



Artistic Impression

Lounge Area

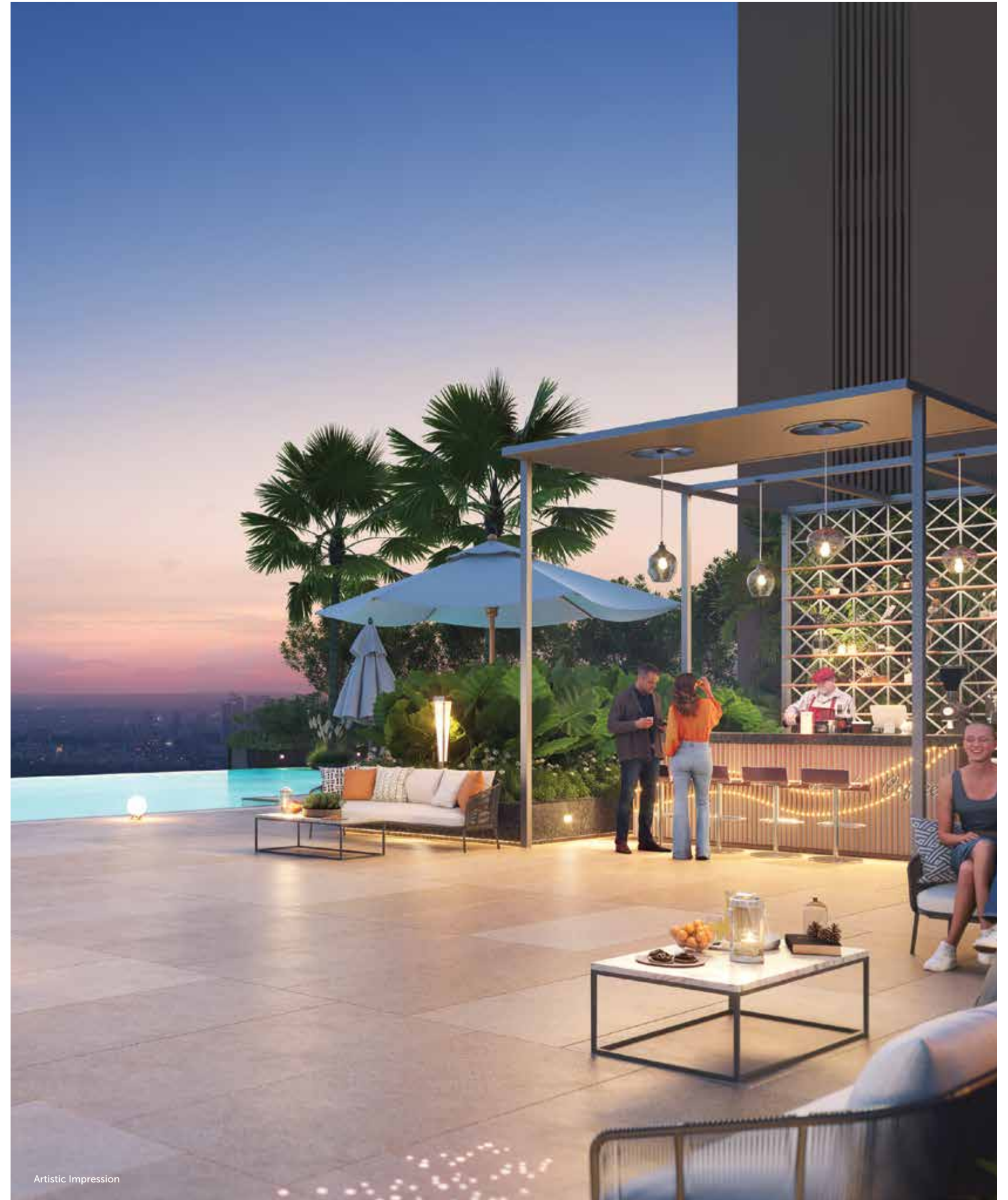

Artistic Impression

Pool Complex

# INDOOR AMENITIES





Cardio



Salon



Crèche



Co-working Space



Conceptual Image

## FINISHES & SPECIFICATIONS

### Flooring

- 800mm. X 1600mm. double charged vitrified flooring for living, dining, kitchen, and bedrooms
- Wooden anti-skid tiles for attach terraces / anti-skid tiles for bathroom flooring

### Bathrooms

- GVT tiles for toilet dado upto lintel level
- Solar hot water system for all attached toilets (Solar and heat pump combined)
- High-quality CP & sanitary fittings with wall hung commode in all toilets
- 2ft. X 2ft. grid false ceiling in all toilets
- High-quality CP and sanitary fittings with wall hung commode in all toilets (Grohe / Toto or equivalent make)

### Wall Finish

- Gypsum finish internal walls
- Lustre paint for entire flat

### Doors & Windows

- Veneer finish main door with biometric lock
- Internal laminate doors with mortise locks for bedrooms & bathrooms
- Aluminium system doors and windows with toughened glass
- Glass partition for shower area in all attached toilets

### Balcony

- SS railing with laminated glass for terraces

### Electrification

- High-quality switches and wiring with adequate number of light points, TV / Telephone / AC points in all rooms
- D.G. backup for all electrical points in flats except power points
- DTH provision in flats & VDP for each flat
- Exhaust fans for all toilets

### Kitchen

- Engineered stone-top for kitchen platform with stainless steel sink
- Dado upto lintel level
- Provision of Aquaguard point in kitchen

### Others

- Earthquake resistant RCC structure
- High speed elevators for each building
- Access controlled lobbies
- MNGL gas pipeline provision in all apartments
- CCTV cameras in common areas
- Internal walls with lightweight AAC blocks

## CREDITS

PROJECT ARCHITECT  
**ABA - Amit Bhat Architects**

STRUCTURAL CONSULTANT  
**JW Consultants LLP**

FIRE FIGHTING & MEP CONSULTANT  
**Eskayem**

LANDSCAPE CONSULTANT  
**Design Terra**

STP CONSULTANT  
**Deccan Environmental**

ARCHITECTURAL LIAISONING  
**SuPa Associates**

EC CONSULTANT  
**ACE Environment**

BRAND COMMUNICATION  
**Filament Communique**





**Site Address:** Sr. No. 5, Beside Blue Water Restaurant, Aundh - Ravet BRTS Road, Punawale, Pimpri - Chinchwad, Pune - 411 033.

**Corporate Address:** ANP ONE, 109 Balewadi High Street, Near Cummins Baner, Pune - 411 045.

 **74117 82361**



 MahaRERA NO.: P52100051641  
<https://maharera.mahaonline.gov.in>

Disclaimer: This document's content is solely for informational purposes and is not intended to constitute an offer or solicitation. It is an artistic impression / schematic representation of the project and is indicative of how the unit can be used. This document does not constitute an offer and / or contract of any type between the developer / promoter / owner, and the recipient. All intending purchaser/s in this project shall be governed by the terms and conditions envisaged under The Real Estate (Regulation and Development) Act 2016. Nothing in this document should be misconstrued as advertising, marketing, booking, selling or an offer for sale or invitation to purchase a unit in any project by the company / firm. The company / firm is not responsible for the consequences of any action taken by the viewer relying on such material/information in this brochure.